

LAND USE PLAN JACKSON TOWNSHIP

COUNTY OF SACRAMENTO, CALIFORNIA

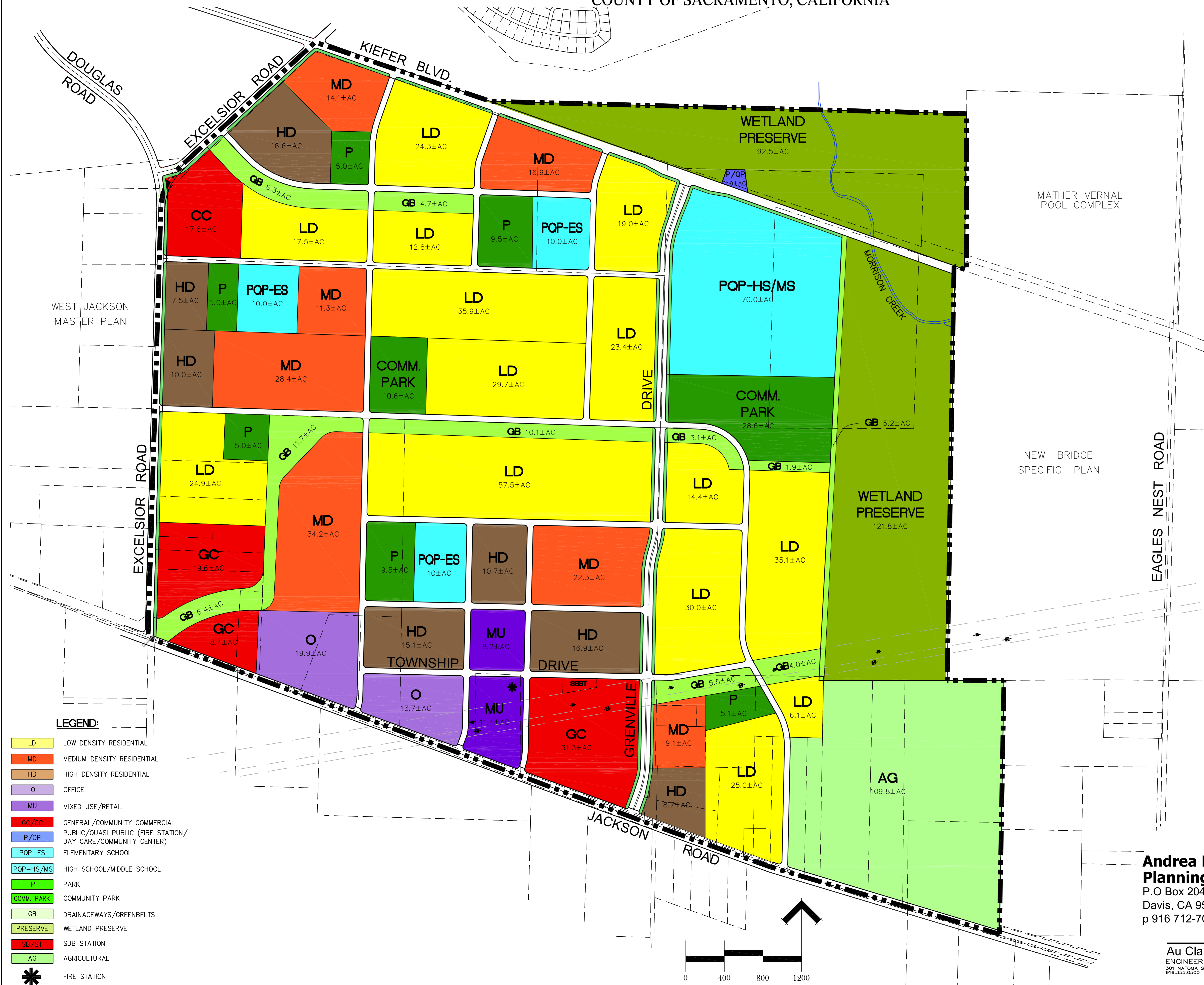
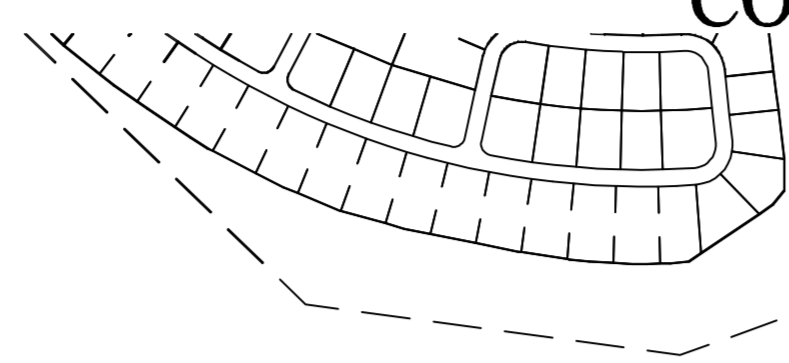

LEGEND:

- LD LOW DENSITY RESIDENTIAL
- MD MEDIUM DENSITY RESIDENTIAL
- HD HIGH DENSITY RESIDENTIAL
- O OFFICE
- MU MIXED USE/RETAIL
- GC/CC GENERAL/COMMUNITY COMMERCIAL
- P/QP PUBLIC/QUASI PUBLIC (FIRE STATION/
DAY CARE/COMMUNITY CENTER)
- PQP-ES ELEMENTARY SCHOOL
- PQP-HS/MS HIGH SCHOOL/MIDDLE SCHOOL
- P PARK
- COMM. PARK COMMUNITY PARK
- GB DRAINAGEWAYS/GREENBELTS
- PRESERVE WETLAND PRESERVE
- SB/ST SUB STATION
- AG AGRICULTURAL
- ✱ FIRE STATION

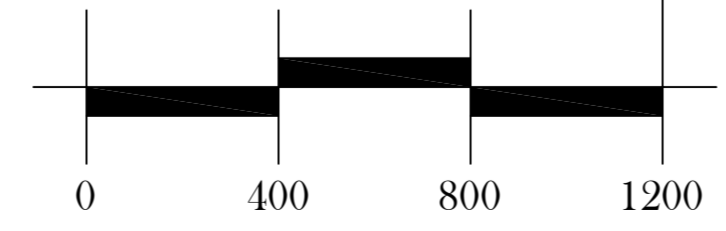

JUNE 16, 2017

**Andrea Mayer Consulting
Planning + Design**
P.O. Box 2042
Davis, CA 95617
p 916 712-7059

Au Clair Consulting
ENGINEERS AND SURVEYORS
301 NATOMA ST #201 FOLSOM, CA 95630
916.555.0500

P:\2017-001\Excelsior\DWG\2017-001-LUP-Jackson_Township.dwg, Admin, 13:16:37, 06-21-17