

COMMUNITY PLAN AMENDMENT

BARRETT RANCH EAST

COUNTY OF SACRAMENTO, CALIFORNIA

DECEMBER 20, 2013
 (REVISED: MAY 19, 2014)
 (REVISED: MARCH 8, 2016)
 (REVISED: AUGUST 3, 2016)

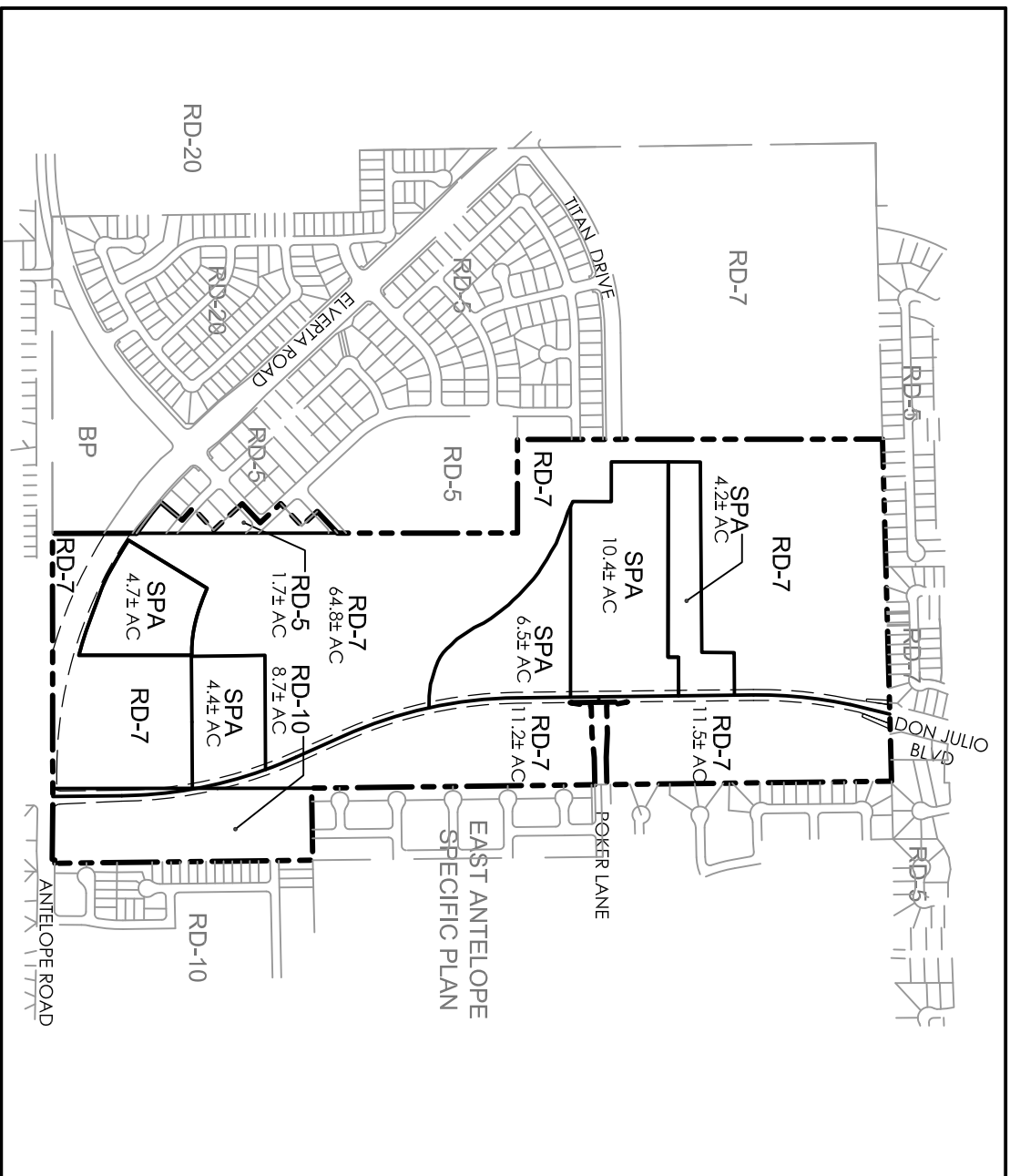

Existing Community Plan

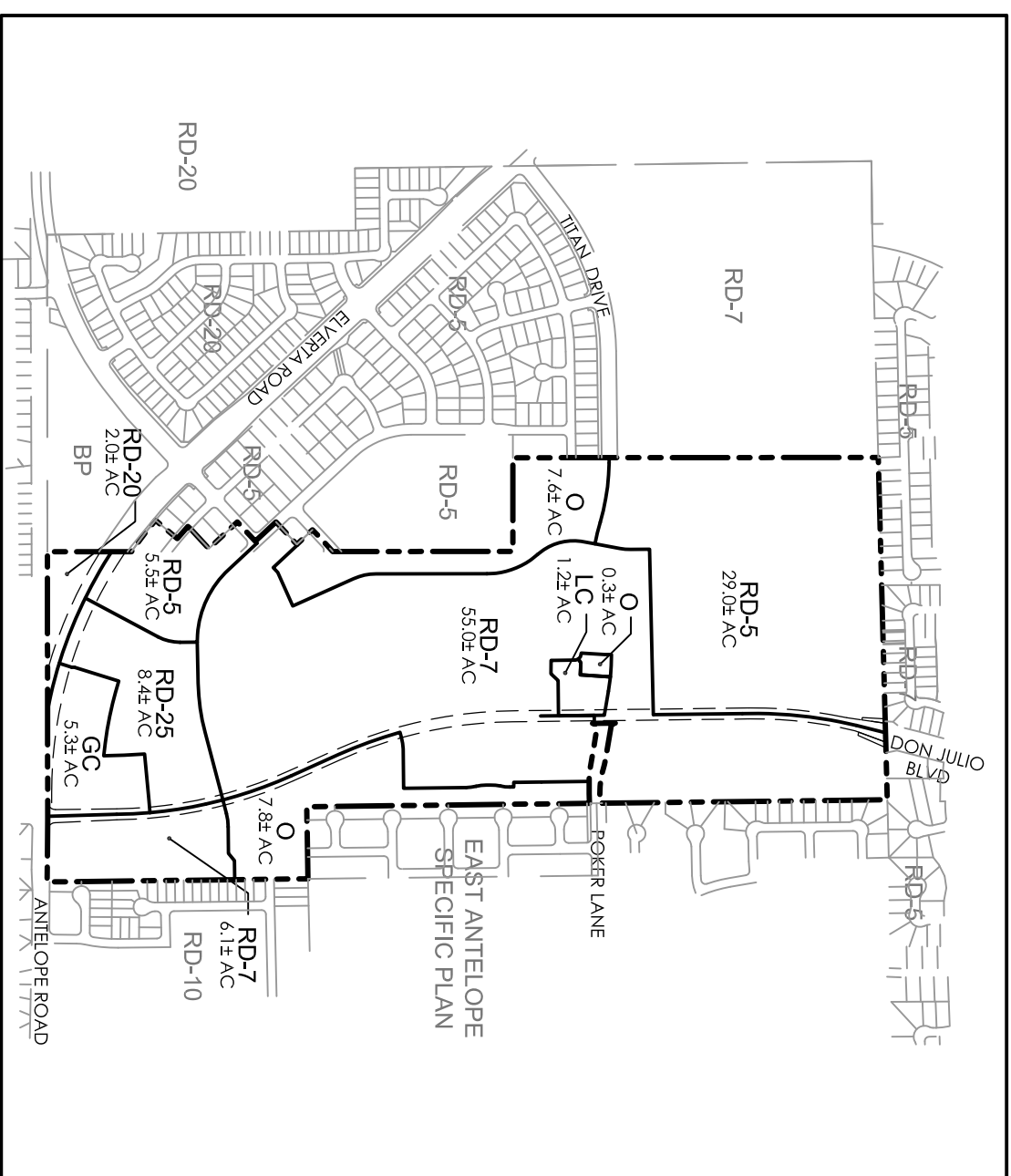

Proposed Community Plan

COMMUNITY PLAN SUMMARY TABLE

DESIGNATION	LAND USE	EXISTING	PROPOSED	DIFFERENCE
SPA	SPECIAL PLANNING AREA	30.2	0	-30.2
GC	GENERAL COMMERCIAL	0	5.3	+5.3
LC	LIGHT COMMERCIAL	0	1.2	+1.2
O	RECREATION (PARKS & OPEN SPACE)	0	15.7	+15.7
RD-5	LOW DENSITY RESIDENTIAL	1.7	34.5	+32.8
RD-7	LOW DENSITY RESIDENTIAL	87.5	61.1	-26.4
RD-10	LOW DENSITY RESIDENTIAL	8.7	0	-8.7
RD-20	MEDIUM DENSITY RESIDENTIAL	0	2.0	+2.0
RD-25	MEDIUM DENSITY RESIDENTIAL	0	8.4	+8.4
		128.1	128.2	

