



Jesuit High School Stadium
Lighting
Environmental Impact Report

Public Scoping Meeting

PLNP2021-00262

Planning and Environmental Review
December 7th, 2022

Introductions

Sacramento County Planning and Environmental Review:

- Carol Gregory, Associate Environmental Analyst
- Rebecca Boschee, Associate Environmental Analyst
- Meg de Courcy, Senior Planner
- Kimber Gutierrez, Project Manager
- Todd Smith, Planning Director

Agenda and Rules of Meeting

- Brief Power Point Presentation
- Comment and question period to follow the presentation
- If you would like to speak after the presentation, please respond in the chat feature with your name
- If participating via phone only, please wait for an invitation to those on the phone only to speak
- If there are several speakers who wish to participate, comments and questions may be limited to 3 minutes
- Please indicate when commenting if you would like to be added to the mailing list for the project

Meeting Purpose

- Gather input for the Environmental Impact Report (EIR):
 - What environmental topics should be our focus?
 - What alternatives and mitigation measures should we consider?
 - What concerns regarding the potential impacts of the proposed project shall we document?
- Public input will be used to develop the “scope” of the EIR

CEQA Overview

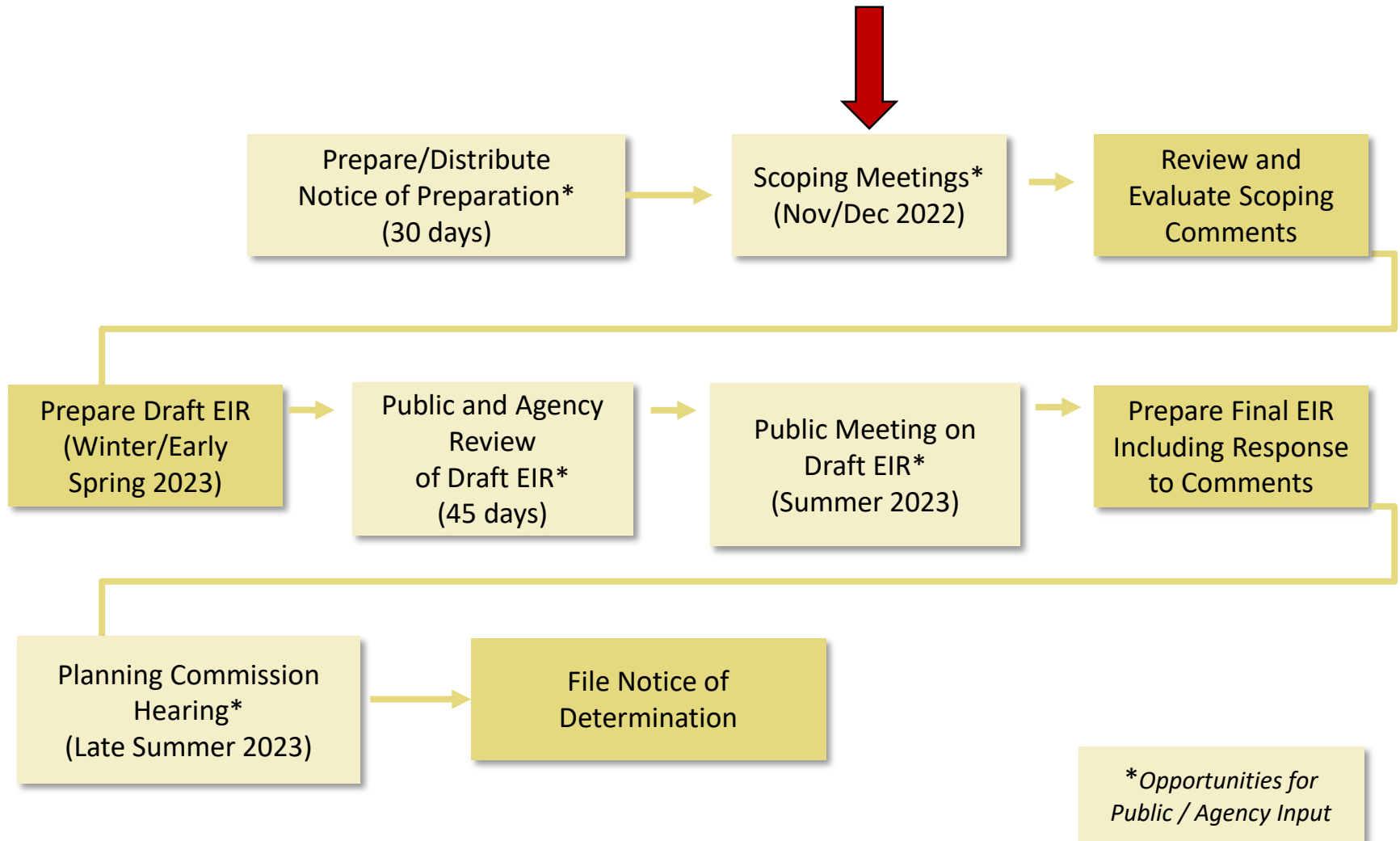

Project Overview

Location:

- Carmichael Community
- On Jesuit High School Campus
- North side of American River Drive
- West side of Jacob Lane
- East side of Piccadilly Circle

Project Site:

- One parcel totaling 20.22 Acres
- APN: 289-0210-045
- Location of Jesuit High School's sports facilities

Project Summary:

- 4 permanent stadium light poles at Marauder Stadium
- Additional code complaint lighting for bleachers/pedestrian pathways of stadium

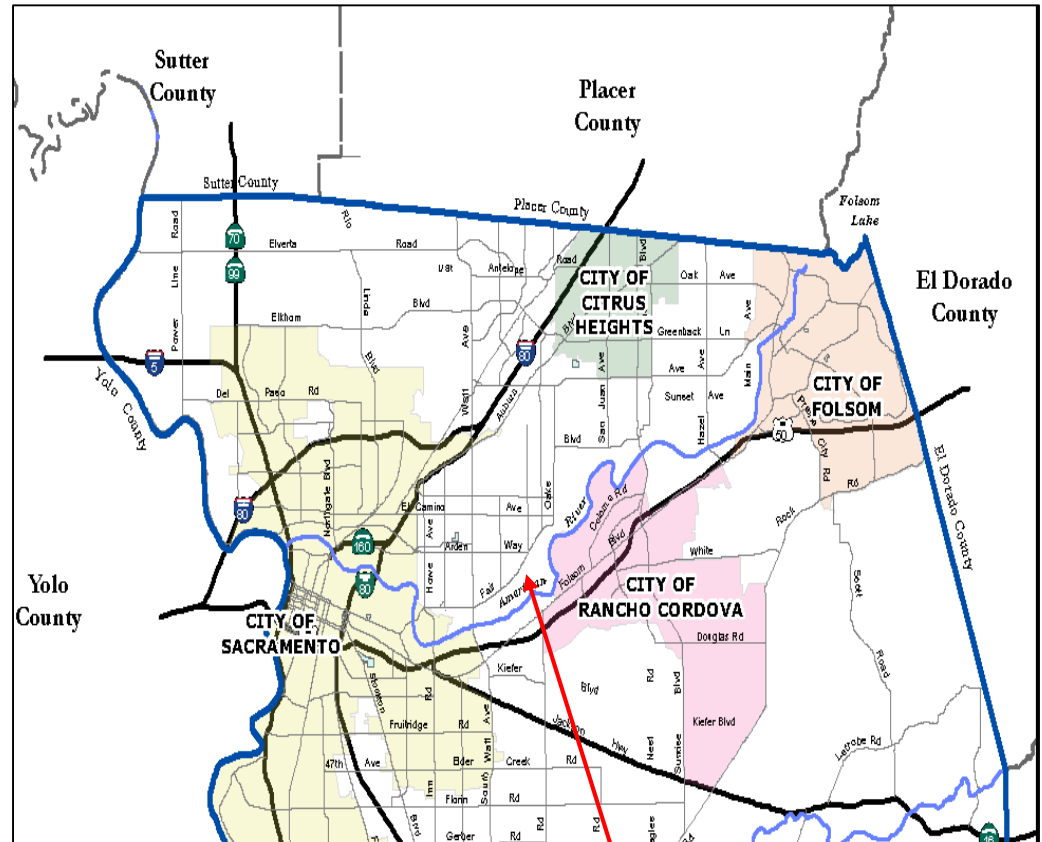

Project Entitlement Request

1. A **Use Permit Amendment** to allow stadium lighting on the Jesuit High School athletic field in the Residential 4 (RD-4) zoning district.
2. A **Design Review** to determine substantial compliance with the *Sacramento County Countywide Design Guidelines* (Design Guidelines).

Project Site

Jesuit's Main Campus

Jesuit's Marauder Stadium



Project Description

- Two of the light poles, located at the north of the stadium, would be 100 feet high.
- The other two light poles, located on the south side of the stadium, would be 90-feet high.
- The proposed light poles will have LED lights affixed to the top and will be located at the 10-yard lines of the football field.
- The surrounding land uses are all single-family residential with RD-4 zoned properties. The American River Parkway is approximately 0.3 miles from the project site. Rio Americano High School is approximately 0.2 miles from the project site.

Preliminary Site Plan

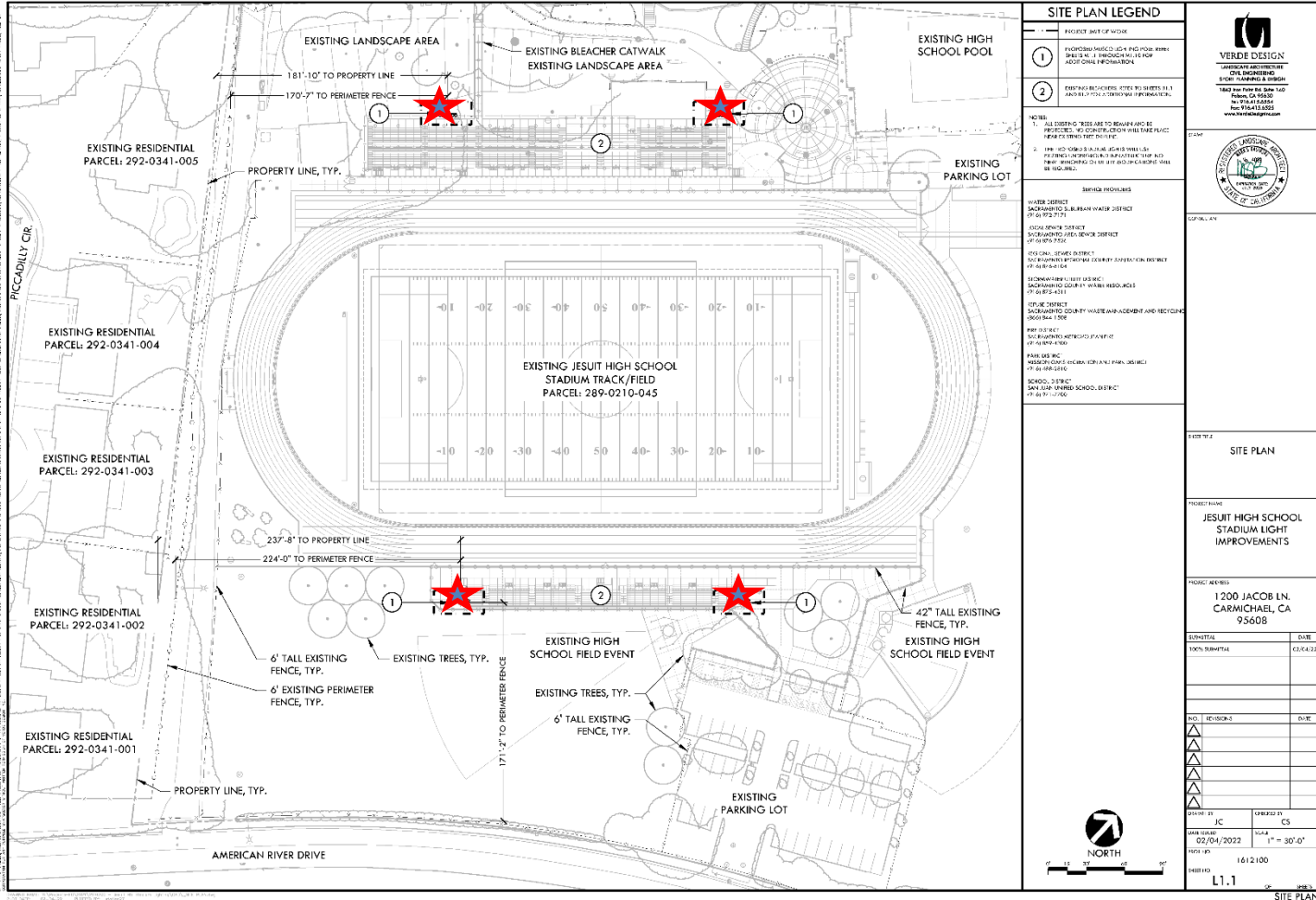

Representative Photos



North side of stadium, looking southwest

North side of stadium, looking southeast



Representative Photos (cont.)



View from football field, looking northeast

South side of stadium, looking west



Project Objectives (provided by Applicant)

- Provide a feasible location at which to increase athletic opportunities for Jesuit High School students by hosting on-campus sports competitions during evening hours.
- Allow for athletic practices and competition to occur after the peak afternoon hours during times with more favorable weather conditions to protect the health and safety of student athletes, coaches, and spectators.
- Provide sufficient time, particularly for Fall and Winter sports, to train and compete without requiring student athletes to miss excessive classroom instruction multiple times per month.
- Spread on-campus activities over a broader period of time to reduce the number of individuals and vehicles concurrently utilizing school facilities.

Project Objectives (cont.)

- Enhance the overall high school athletic experience for students, parents, alumni, and the Sacramento community; and
- Continue to build upon Jesuit's reputation for athletic excellence by providing facilities that allow athletes to achieve peak performance.

EIR Content

- The EIR will include the following chapters:
 - Executive summary
 - Introduction
 - Project description
 - Setting, impacts, and mitigation measures
 - Alternatives
 - Cumulative impacts
 - Other CEQA-required topics

EIR Topics

- Preliminary List of EIR Topics:
 - Aesthetics and Visual Resources
 - Air Quality/GHG Emissions
 - Biological Resources
 - Cultural and Tribal Cultural Resources
 - Hydrology and Water Quality
 - Land Use
 - Noise
 - Traffic/Vehicle Miles Traveled (VMT)
 - Energy
 - Public Services

Scoping Comments

Verbal input provided today will be reflected and addressed in the EIR, as appropriate.

Relevant comments to preparation of the EIR include:

- Potentially **significant environmental impacts**
- Possible ways to **mitigate environmental impacts**
- **Alternatives** to the project the reduce or minimize impacts
- Other concerns that relate to adverse environmental consequences
- Comments strictly concerning the merits of the project are not applicable to the EIR if there is no related environmental effect
- Comments on the merits of the project forwarded to Planning Staff

Scoping Comments

NOP comment period ended November 28th, 2022

The County will accept comments throughout the preparation of the EIR.

Written comments to:

Joelle Inman, Environmental Coordinator

Planning and Environmental Review

827 7th Street, Room 225, Sacramento, CA 95814

or via e-mail at: CEQA@saccounty.gov

In response to advertisement of the NOP, PER is saving and tracking all of the written comments received.